

CHECK VALVE

CV01 Series



Features

- Maximum working pressure:
6000psi (414 bar)
- Working temperature:
-23°C to 200°C (-10°F to 392°F)
- Cracking pressure:
1 to 25 psi
- Fixed cracking pressures

Pressure Vs. Temperature

Material		316 SS	
Temperature		Working Pressure	
°C	°F	Psi	Bar
38	100	6000	414
93	200	2500	172
121	250	1630	112
150	302	1545	106
200	392	1450	100

Cracking Pressure and Resealing Pressure

- Cracking pressure is the upstream pressure at which the first indication of flow occurs.
- Resealing pressure is the pressure at which there is no indication of flow.

CV01 Series

Nominal Cracking Pressure psi (bar)	Cracking Pressure Range psi (bar)	Resealing Pressure Range psi (bar)
1 (0.06)	Up to 4 (0.27)	Up to 6 (0.41) back pressure
5 (0.34)	3 to 9 (0.20 to 0.62)	Up to 2 (0.13) back pressure
10 (0.68)	7 to 15 (0.48 to 1.0)	3 (0.20) or higher upstream pressure
25 (1.7)	20 to 30 (1.3 to 2.0)	17 (1.1) or higher upstream pressure

Material of Construction

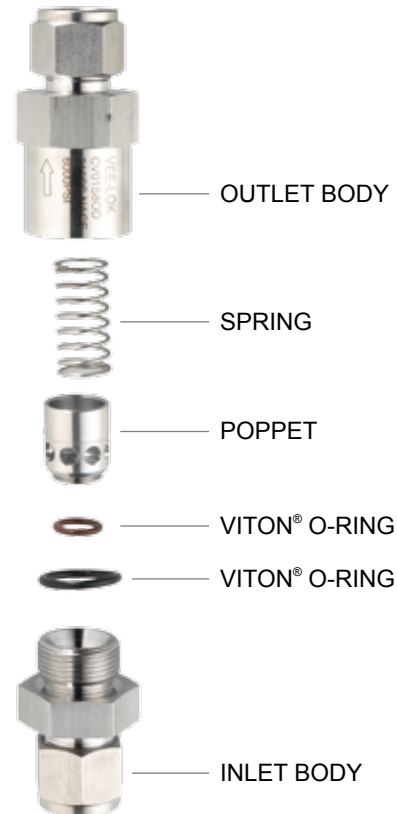

Component	Valve Body Material
	316 S.S.
Inlet Body	316 S.S./A479
O-Ring	VITON [®]
O-Ring	VITON [®]
Poppet	316 S.S./A479
Spring	302 S.S./A313
Outlet Body	316 S.S./A479



For valves not actuated for a period of time, initial cracking pressure may be higher than the set pressure.

Dimensions

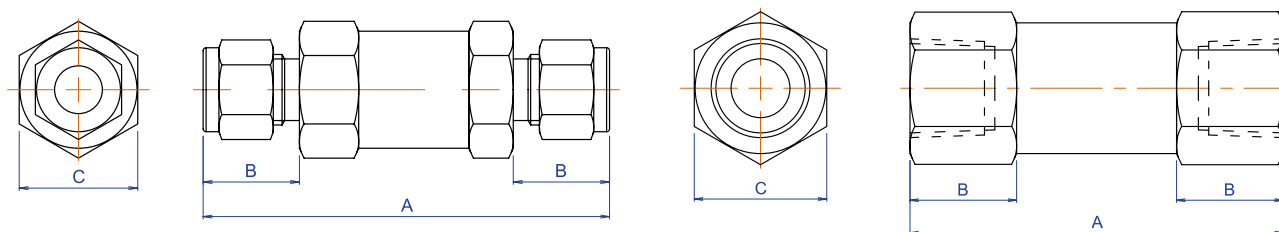

Ordering No.	End Connection		Dimensions (mm)		
	Inlet	Outlet	A	B	C
CV01S2FF	1/8" NPT female	1/8" NPT female	55	14	17
CV01S4FF	1/4" NPT female	1/4" NPT female	62	16	22
CV01S6FF	3/8" NPT female	3/8" NPT female	72	20	24
CV01S8FF	1/2" NPT female	1/2" NPT female	80.5	23	28.58
CV01S12FF	3/4" NPT female	3/4" NPT female	85	22	41
CV01S16FF	1" NPT female	1" NPT female	97	23	47.6
CV01S2OD	1/8" O.D.	1/8" O.D.	65.5	15.5	17
CV01S4OD	1/4" O.D.	1/4" O.D.	73	17.5	20.63
CV01S6OD	3/8" O.D.	3/8" O.D.	80.5	19.5	24
CV01S8OD	1/2" O.D.	1/2" O.D.	90.5	22	28.58
CV01SM6OD	6mm O.D.	6mm O.D.	73	17.5	20.63
CV01SM12OD	12MM O.D.	12MM O.D.	90.5	22	28.58

All dimensions shown are for reference and subject to change without prior notice.

Ordering Information

CV01	S		4		FF	
Series	Body Material		Size		End Connection	
CV01	S	316 S.S.	2	1/8"	MF	NPT male-female
			4	1/4"	FF	NPT female-female
			6	3/8"	OD	VEE-LOK twin ferrule tube fittings
			8	1/2"		
			12	3/4"		
			16	1"		
			M6	6mm		
			M12	12mm		