

Ordering Numbers and Dimensions

- See **How to Order**, below. Minimum order quantities may apply to certain materials and configurations.
- Dimensions are for reference only and are subject to change. Unless noted otherwise, dimensions shown are for stainless steel components and with Swagelok nuts finger-tight. For Swagelok nut dimensions, see page 50.
- CAD templates are available on www.swagelok.com.

Straight Fittings

Unions

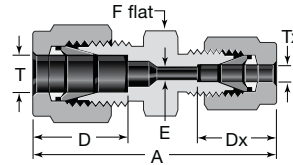
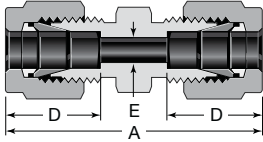

Union

Tube OD	Basic Ordering Number	Dimensions		
		A	D	E
Dimensions, in.				
1/16	-100-6	0.99	0.34	0.05
1/8	-200-6	1.40	0.50	0.09
3/16	-300-6	1.47	0.54	0.12
1/4	-400-6	1.61	0.60	0.19
5/16	-500-6	1.69	0.64	0.25
3/8	-600-6	1.77	0.66	0.28
1/2	-810-6	2.02	0.90	0.41
1/2	-810-6-0030 ^①	4.30	—	0.50
5/8	-1010-6	2.05	0.96	0.62
3/4	-1210-6	2.11		
7/8	-1410-6	2.17	1.02	0.72
1	-1610-6	2.55	1.23	0.88
1 1/8	-1810-6			0.97
1 1/4	-2000-6	3.63	1.62	1.09
1 1/2	-2400-6	4.25	1.97	1.34
2	-3200-6	5.88	2.66	1.81
Dimensions, mm				
2	-2M0-6	35.6	12.9	1.7
3	-3M0-6	35.3		2.4
4	-4M0-6	37.3	13.7	2.4
6	-6M0-6	41.0	15.3	4.8
8	-8M0-6	43.2	16.2	6.4
10	-10M0-6	46.2	17.2	7.9
12	-12M0-6	51.2	22.8	9.5
14	-14M0-6	52.0	24.4	11.1
15	-15M0-6			11.9
16	-16M0-6			12.7
18	-18M0-6			15.1
20	-20M0-6	55.0	26.0	15.9
22	-22M0-6			18.3
25	-25M0-6	65.0	31.3	21.8
28	-28M0-6	85.0	36.6	
	B-28M0-6	65.4	31.6	24.6
30	-30M0-6	92.7	39.6	26.2
32	-32M0-6	97.3	42.0	28.6
38	-38M0-6	114	49.4	33.7
50	-50M0-6	146	65.0	45.2

^① Bored through.

Union (Metric to Fractional)

Tube OD		Basic Ordering Number	Dimensions								
T	Tx, in.		A	D	Dx	E	F				
Dimensions, mm											
2	1/8 1/4	-2M0-6-2 -2M0-6-4	35.2 38.6	12.9	12.8 15.3	1.7	12 14				
3	1/8	-3M0-6-2	35.2	12.9	12.8	2.4	12				
4	1/8 1/4	-4M0-6-2 -4M0-6-4	36.5 39.4	13.7	12.8 15.3	2.4	12 14				
	6	1/16 1/8 1/4 5/16 3/8	-6M0-6-1 -6M0-6-2 -6M0-6-4 -6M0-6-5 -6M0-6-6	34.3 38.5 41.0 42.3 43.2	15.3	8.6 12.8 15.3 16.2 16.8	1.3 2.4 4.8 4.8 4.8	14 14 14 14 16			
8		1/4 3/8	-8M0-6-4 -8M0-6-6	42.3 44.3		16.2	15.3 16.9	4.8 6.4	15 16		
		10	1/8 1/4 5/16 3/8	-10M0-6-2 -10M0-6-4 -10M0-6-5 -10M0-6-6		41.8 44.5 45.1 45.9	17.2	12.8 15.3 16.2 16.9	2.4 4.8 6.4 7.1	18	
12			1/4 5/16 3/8 1/2	-12M0-6-4 -12M0-6-5 -12M0-6-6 -12M0-6-8		47.0 47.8 48.4 51.2		22.8	15.3 16.2 16.9 22.9	4.8 6.4 7.1 9.5	22
	14		1/2	-14M0-6-8	52.0	24.4			22.9	10.3	24
	15		1/2	-15M0-6-8	52.0	24.4			22.9	10.3	24
	16	5/8	-16M0-6-10	52.0	24.4	24.4	12.7		24		
18	3/4	-18M0-6-12	53.5	24.4	24.4	15.1	27				
20	1/2 1	-20M0-6-8 -20M0-6-16	55.0 62.8	26.0	22.9 31.3	10.3 15.9	30 35				
	25	1	-25M0-6-16		65.0	31.3	31.3	21.8	35		

How to Order

Select a basic ordering number. Example **-100-6**

Add a material designator. Example: **SS-100-6**

Material	Designator	Material	Designator
316 SS	SS	Alloy 2507	2507
Aluminum	A	Alloy C-276	HC
Alloy 20	C20	Brass	B
6-Moly	254	Carbon steel	S
Alloy 400	M	Nylon	NY
Alloy 600	INC	PTFE	T
Alloy 625	625	Titanium (grade 4)	TI
Alloy 825	825		

Refer to Installation Instructions, beginning on page 62.

Straight Fittings

Unions

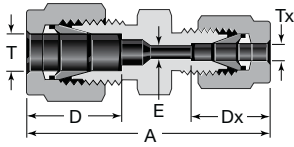

Reducing Union

Tube OD		Basic Ordering Number	Dimensions			
T	Tx		A	D	Dx	E
Dimensions, in.						
1/8	1/16	-200-6-1	1.22	0.50	0.34	0.05
3/16	1/16	-300-6-1	1.27	0.54	0.34	0.05
	1/8	-300-6-2	1.44		0.50	0.09
1/4	1/16	-400-6-1	1.35	0.60	0.34	0.05
	1/8	-400-6-2	1.52		0.50	0.09
	3/16	-400-6-3	1.55		0.54	0.12
5/16	1/8	-500-6-2	1.56	0.64	0.50	0.09
	1/4	-500-6-4	1.66		0.60	0.19
3/8	1/16	-600-6-1	1.44	0.66	0.34	0.05
	1/8	-600-6-2	1.61		0.50	0.09
	1/4	-600-6-4	1.70		0.60	0.19
	5/16	-600-6-5	1.74		0.64	0.25
1/2	1/8	-810-6-2	1.78	0.90	0.50	0.09
	1/4	-810-6-4	1.85		0.60	0.19
	3/8	-810-6-6	1.91		0.66	0.28
5/8	3/8	-1010-6-6	1.94	0.96	0.66	0.28
	1/2	-1010-6-8	2.05		0.90	0.41
3/4	1/4	-1210-6-4	1.94	0.96	0.60	0.19
	3/8	-1210-6-6	2.00		0.66	0.28
	1/2	-1210-6-8	2.11		0.90	0.41
	5/8	-1210-6-10	2.11		0.96	0.50
1	1/2	-1610-6-8	2.38	1.23	0.90	0.41
	3/4	-1610-6-12			0.96	0.62
Dimensions, mm						
3	2	-3M0-6-2M	35.3	12.9	12.9	1.7
6	2	-6M0-6-2M	38.6	15.3	12.9	1.7
	3	-6M0-6-3M	38.6		12.9	2.4
	4	-6M0-6-4M	39.4		13.7	2.4
8	6	-8M0-6-6M	42.3	16.2	15.3	4.8
10	6	-10M0-6-6M	44.5	17.2	15.3	4.8
	8	-10M0-6-8M	45.1		16.2	6.4
12	6	-12M0-6-6M	47.0	22.8	15.3	4.8
	8	-12M0-6-8M	47.8		16.2	6.4
	10	-12M0-6-10M	48.7		17.2	7.9
14	12	-14M0-6-12M	48.8	24.4	22.8	6.4
15	12	-15M0-6-12M	48.8	24.4	22.8	6.4
16	10	-16M0-6-10M	49.5	24.4	17.2	7.9
	12	-16M0-6-12M	52.0		22.8	9.5
18	12	-18M0-6-12M	53.5	24.4	22.8	9.5
25	18	-25M0-6-18M	61.0	31.3	24.4	15.1
	20	-25M0-6-20M	62.3		26.0	15.9
30	18	-30M0-6-18M	75.4	39.6	24.4	15.1
	20	-30M0-6-20M	75.4		26.0	15.9
	25	-30M0-6-25M	80.1		31.3	21.8
32	18	-32M0-6-18M	77.8	42.0	24.4	15.1
	20	-32M0-6-20M	77.8		26.0	15.9
	25	-32M0-6-25M	82.3		31.3	21.8
38	20	-38M0-6-20M	87.5	49.4	26.0	15.9
	25	-38M0-6-25M	92.0		31.3	21.8
	30	-38M0-6-30M	105		39.6	26.2

Refer to Installation Instructions, beginning on page 62.

Straight Fittings

Unions

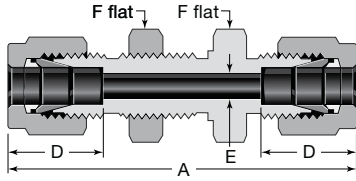

Bulkhead Union

Tube OD	Basic Ordering Number	Dimensions								
		A	D	E	F	Panel Hole Size	Max Panel Thickness			
Dimensions, in.										
1/16	-100-61	1.24	0.34	0.05	5/16	13/64	0.12 ^①			
1/8	-200-61	2.02	0.50	0.09	1/2	21/64	0.50			
3/16	-300-61	2.11	0.54	0.12	9/16	25/64				
1/4	-400-61	2.27	0.60	0.19	5/8	29/64	0.40			
5/16	-500-61	2.39	0.64	0.25	11/16	33/64	0.44			
3/8	-600-61	2.45	0.66	0.28	3/4	37/64				
1/2	-810-61	2.80	0.90	0.41	15/16	49/64	0.50			
5/8	-1010-61	2.86	0.96	0.50	1 1/16	57/64				
3/4	-1210-61	3.11	0.96	0.62	1 3/16	1 1/64	0.66			
1	-1610-61	3.77	1.23	0.88	1 5/8	1 21/64	0.75			
1 1/4	-2000-61	4.85	1.62	1.09	1 7/8	1 41/64				
1 1/2	-2400-61	5.48	1.97	1.34	2 1/4	1 61/64				
2	-3200-61	7.10	2.66	1.81	2 3/4	2 41/64				
Dimensions, mm										
3	-3M0-61	51.3	12.9	2.4	14	8.3	12.7			
4	-4M0-61	53.6	13.7	2.4		9.9				
6	-6M0-61	57.7	15.3	4.8	16	11.5	10.2			
8	-8M0-61	61.0	16.2	6.4	18	13.1	11.2			
10	-10M0-61	63.7	17.2	7.9	22	16.3				
12	-12M0-61	71.0	22.8	9.5	24	19.5	12.7			
14	-14M0-61	72.5	24.4	11.1	27	22.5				
15	-15M0-61	72.5	24.4	11.9		22.8				
16	-16M0-61	72.5	24.4	12.7	50	26.0	16.8			
18	-18M0-61	78.9	24.4	15.1						
20	-20M0-61	84.5	26.0	15.9				35	29.0	19.0
25	-25M0-61	96.0	31.3	21.8				41	34.0	
30	-30M0-61	124	39.6	26.2	40.5					
32	-32M0-61	128	42.0	28.6	42.5					
38	-38M0-61	145	49.4	33.7	60	50.5				

① Minimum panel thickness is 0.06 in.

Bulkhead Reducing Union

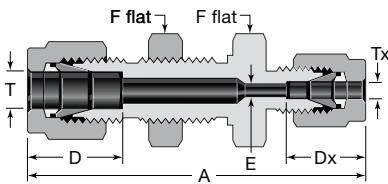

Tube OD		Basic Ordering Number	Dimensions						
T	Tx		A	D	Dx	E	F	Panel Hole Size	Max Panel Thickness
Dimensions, in.									
1/8	1/16	-200-61-1	1.85	0.50	0.34	0.05	1/2	21/64	0.50
1/4	1/8	-400-61-2	2.17	0.60	0.50	0.09	5/8	29/64	0.40
3/8	1/4	-600-61-4	2.39	0.66	0.60	0.19	3/4	37/64	0.44
1/2	1/4	-810-61-4	2.63	0.90			15/16	49/64	0.50

Bulkhead Reducing Union (Metric to Fractional)

Tube OD		Basic Ordering Number	Dimensions						
T	Tx, in.		A	D	Dx	E	F	Panel Hole Size	Max Panel Thickness
Dimensions, mm									
6	1/8	-6M0-61-2	55.1	15.3	12.7	2.4	16	11.5	10.2

Refer to Installation Instructions, beginning on page 62.