



# Standard Specification for Copper-Brazed Steel Tubing<sup>1</sup>

This standard is issued under the fixed designation A254/A254M; the number immediately following the designation indicates the year of original adoption or, in the case of revision, the year of last revision. A number in parentheses indicates the year of last reapproval. A superscript epsilon ( $\epsilon$ ) indicates an editorial change since the last revision or reapproval.

*This standard has been approved for use by agencies of the U.S. Department of Defense.*

## 1. Scope

1.1 This specification covers double-wall, copper-brazed steel tubing suitable for general engineering uses, particularly in the automotive, refrigeration, and stove industries for fuel lines, brake lines, oil lines, heating and cooling units, and the like. The tubing is available in either of two types, single strip or double strip as shown in Fig. 1.

1.2 *Units*—This specification is expressed in both inch-pounds units and in SI units; however, unless the purchase order or contract specifies the applicable M specification designation (SI units), the inch-pound units shall apply. The values stated in either inch-pound units or SI units are to be regarded separately as standard. Within the text, the SI units are shown in brackets. The values stated in each system may not be exact equivalents; therefore, each system shall be used independently of the other. Combining values from the two systems may result in non-conformance with the standard. In this specification hard or rationalized conversions apply to diameters, lengths, and tensile properties. Soft conversion applies to other SI measurements.

## 2. Referenced Documents

2.1 *ASTM Standards*:<sup>2</sup>

A370 Test Methods and Definitions for Mechanical Testing of Steel Products

A751 Test Methods, Practices, and Terminology for Chemical Analysis of Steel Products

E30 Test Methods for Chemical Analysis of Steel, Cast Iron, Open-Hearth Iron, and Wrought Iron (Withdrawn 1995)<sup>3</sup>

E59 Practice for Sampling Steel and Iron for Determination of Chemical Composition (Withdrawn 1996)<sup>3</sup>

<sup>1</sup> This specification is under the jurisdiction of ASTM Committee A01 on Steel, Stainless Steel and Related Alloys and is the direct responsibility of Subcommittee A01.09 on Carbon Steel Tubular Products.

Current edition approved Nov. 1, 2012. Published December 2012. Originally approved in 1944. Last previous edition approved in 2007 as A254 – 97(2007). DOI: 10.1520/A0254\_A0254M-12.

<sup>2</sup> For referenced ASTM standards, visit the ASTM website, www.astm.org, or contact ASTM Customer Service at service@astm.org. For *Annual Book of ASTM Standards* volume information, refer to the standard's Document Summary page on the ASTM website.

<sup>3</sup> The last approved version of this historical standard is referenced on www.astm.org.

2.2 *Society of Automotive Engineers Standard*:<sup>4</sup>

J 533 Flares for Tubing

## 3. Ordering Information

3.1 Orders for material under this specification should include the following, as required to describe the desired material adequately:

3.1.1 Quantity (feet, metres or number of pieces),

3.1.2 Name of material (copper-brazed steel tubing),

3.1.3 Type, single strip or double strip, where necessary (see Fig. 1) (normally the type is not specified),

3.1.4 Size (outside diameter and wall thickness; normally inside diameter should not be specified),

3.1.5 Length (specific or random),

3.1.6 Inside surface cleanliness where required (see Section 8),

3.1.7 External coating, where required (see Section 7 and Supplementary Requirement S2), and

3.1.8 Special or supplementary requirements or exceptions to specification.

## 4. Manufacture

4.1 The steel may be made by any commercially accepted steelmaking process.

4.2 If a specific type of melting is required by the purchaser, it shall be as stated on the purchase order.

4.3 The primary melting may incorporate separate degassing or refining and may be followed by secondary melting, such as electroslag remelting or vacuum-arc remelting. If secondary melting is employed, the heat shall be defined as all of the ingots remelted from a single primary heat.

4.4 Steel may be cast in ingots or may be strand cast. When steel of different grades is sequentially strand cast, identification of the resultant transition material is required. The producer shall remove the transition material by an established procedure that positively separates the grades.

4.5 The tubing shall be made by rolling steel strip into the form of tubing and subsequently copper brazing in a reducing atmosphere.

<sup>4</sup> Available from SAE International (SAE), 400 Commonwealth Dr., Warrendale, PA 15096-0001, http://www.sae.org.

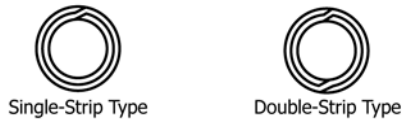

FIG. 1 Brazed Tubing, Double-Wall, 360-deg Brazed Construction

4.6 Tubing shall be constructed as shown in Fig. 1.

4.7 Tubing shall be suitably tested after brazing by the manufacturer to ensure freedom from leaks and detrimental flaws.

5. Chemical Composition

5.1 The steel shall conform to the requirements as to chemical composition prescribed in Table 1.

5.2 Heat Analysis—An analysis of each heat of steel shall be made by the steel manufacturer to determine the percentages of the elements specified. If secondary melting processes are employed, the heat analysis shall be obtained from one remelted ingot or the product of one remelted ingot of each primary melt. The chemical composition thus determined, or that determined from a product analysis made by the tubular product manufacturer shall conform to the requirements specified.

5.3 Product Analysis—Tubing of this quality may be produced in rimmed or capped steel which is characterized by a lack of uniformity in its chemical composition. For this reason, rejection for product analysis is not appropriate unless misapplication is clearly indicated.

5.4 Methods of Analysis—Methods described in Test Methods E30 shall be used for referee purposes. Due allowance shall be made for the presence of copper brazing metal.

5.5 Samples for Product Analysis—Except for spectrographic analysis, samples shall be taken in accordance with Practice E59.

6. Mechanical Requirements

6.1 Tension Test—Tensile properties of tubing as manufactured (prior to cold working) shall conform to the requirements specified in Table 2.

6.1.1 The specimens and tension tests required shall be made in accordance with Test Methods and Definitions A370.

6.1.2 Specimens shall be tested at room temperature.

6.1.3 Test specimens shall be taken from the ends of finished tubes prior to upsetting, swaging, expanding, or other forming operations, or being cut to length. They shall be smooth on the ends and free from burrs and flaws.

6.1.4 If any test specimen shows flaws or defective machining, it may be discarded and another specimen substituted.

TABLE 1 Chemical Requirements

Element	Composition, %
Carbon	0.05 to 0.15
Manganese	0.27 to 0.63
Phosphorus, max	0.035
Sulfur, max	0.035

TABLE 2 Tensile Requirements

Property	Requirement
Tensile strength, min, psi [MPa]	42 000 [290]
Yield strength, min, psi [MPa]	25 000 [170]
Elongation in 2 in. [50 mm] min, %	25

6.1.5 The yield strength shall be determined as that corresponding to a permanent offset of 0.2 % of the gage length of the specimen, or a total extension of 0.5 % of the gage length under load.

6.1.6 If the percentage of elongation of any test specimen is less than that specified and any part of the fracture is more than 3/4 in. [19 mm] from the center of the gage length, as indicated by scribe marks on the specimen before testing, a retest shall be allowed.

6.2 Flattening Test—A section of tubing, not less than 2 1/2 in. [65 mm] in length, shall stand being flattened between parallel plates until the inside walls are in contact without cracking or otherwise showing flaws.

6.3 Expansion Test—A section of tubing approximately 4 in. [100 mm] in length shall stand being expanded over a tapered mandrel having a slope of 1 in 10 until the outside diameter at the expanded end is increased 20 % without cracking or otherwise showing flaws. (Prior to the expansion test, tubing shall be cut off square, edge crowned, and deburred. It shall be held firmly and squarely in the die, and punch must be guided on the axis of the tubing.)

6.4 Bend Test—The finished tubing shall stand bending on a centerline radius equal to three times the tubing outside diameter without kinking, cracking, or developing other flaws where proper bending fixtures are used.

6.5 Pressure Proof Tests—Each tube shall be capable of withstanding, without bursting or leaking, either of the following proof tests:

6.5.1 An internal hydrostatic pressure sufficient to subject the material to a minimum fiber stress of 16 000 psi [110 MPa]. Hydrostatic pressure shall be determined by the following formula:

$$P = 2St/D$$

where:

- P = hydrostatic pressure, psi [MPa],
- S = allowable fiber stress, 16 000 psi [110 MPa],
- t = actual wall thickness of tubing, in. [mm], and
- D = actual outside diameter of tubing, in. [mm].

6.5.2 An underwater air pressure between 225 and 250 psi [1.55 and 1.73 MPa].

7. Coating

7.1 Tubing may be furnished with a copper coating on the inside and outside surfaces, at the option of the manufacturer.

8. Inside Surface Cleanliness

8.1 When inside surface cleanliness is specified by the purchaser, tubing for certain uses, such as refrigeration condensers, shall conform to the following requirement for internal cleanliness:

8.1.1 When a length of tubing is washed internally with redistilled chloroform or redistilled 1,1,1-trichloroethane, the residue remaining upon evaporation of the solvent shall not exceed  $1.25 \times 10^{-4}$  g/in.<sup>2</sup> [0.194 g/m<sup>2</sup>] of internal surface. To perform the test, pour 100 mL of solvent through the tubing and collect. The total length of tubing tested should not be less than 40 ft [12 m], although this total length may be obtained by washing several separate lengths and pouring the same solvent through each in succession. Evaporate the solvent in a steam or hot water bath, and dry at 110°C [230°F] until the vapors are completely removed.

8.2 To maintain this level of cleanliness in shipping, handling, and storage, the purchaser may request that the manufacturer seal the tube ends with caps or closures.

## 9. Dimensional Tolerances

9.1 The tubing shall conform to the permissible variations in [Table 3](#), [Table 4](#), and [Table 5](#).

## 10. Workmanship, Finish, and Appearance

10.1 Finished tubing shall be clean, smooth and round, both inside and outside, and shall be free of rust, scale, and defects that impair processing and serviceability. Finished tubes shall be reasonably straight.

## 11. Retests

11.1 If the results of the mechanical tests of any group or lot do not conform to the requirements specified in the individual specification, retests may be made on additional tubes of double the original number from the same group or lot, each of which shall conform to the requirements specified.

## 12. Retreatment

12.1 If the individual tubes or the tubes selected to represent any group or lot fail to conform to the test requirements, the individual tubes or the group or lot represented may be retreated and resubmitted for test. Not more than two reheat treatments shall be permitted.

## 13. Inspection

13.1 The inspector representing the purchaser shall have entry at all times while work on the contract of the purchaser is being performed, to all parts of the manufacturer's works that concern the manufacture of the material ordered. The manufacturer shall afford the inspector all reasonable facilities to satisfy him that the material is being furnished in accordance with this specification. All required tests and inspection shall be made at the place of manufacture prior to shipment, unless otherwise specified, and shall be conducted so as not to interfere unnecessarily with the operation of the works.

**TABLE 3 Outside Diameter Requirements**

Specified Outside Diameter, in. [mm]	Variations, in. [mm]
	Plus or Minus
Under $\frac{3}{16}$ [4.75]	0.002 [0.050]
$\frac{3}{16}$ [4.75] through $\frac{3}{8}$ [9.5]	0.003 [0.075]
$\frac{3}{16}$ [11.0] through $\frac{3}{8}$ [16.0]	0.004 [0.100]

**TABLE 4 Wall Thickness Requirements**

Specified Wall Thickness, in. [mm]	Variations, in. [mm]
	Plus or Minus
0.020 [0.50] through 0.030 [0.75]	0.003 [0.08]
0.031 [0.80] through 0.049 [1.25]	0.0035 [0.09]

**TABLE 5 Length Requirements**

Specified Cut Length, in. [m]	Variations, in. [mm]
18 [0.45] and under	±0.03 [±0.75]
Over 18 [0.45] through 40 [1.00]	±0.06 [±1.50]
Over 40 [1.00] through 80 [2.00]	±0.12 [±3.00]
Over 80 [2.05] through 120 [3.0]	±0.25 [±6.35]
Over 120 [3.0]	+1.00 [+25.0], -0.0

## 14. Rejection

14.1 Each length of tubing received from the manufacturer may be inspected by the purchaser and, if it does not meet the requirements of the specification based on the inspection and test method as outlined in the specification, the tubing may be rejected and the manufacturer shall be notified. Disposition of rejected tubing shall be a matter of agreement between the manufacturer and the purchaser.

14.2 Material that fails in any of the forming operations or in the process of installation and is found to be defective shall be set aside, and the manufacturer shall be notified for mutual evaluation of the material's suitability. Disposition of such material shall be a matter for agreement.

## 15. Certification

15.1 When requested on the purchaser's order, a test report, signed by an authorized employee or representative of the manufacturer, shall be furnished to the purchaser to indicate the specification and year date and grade, the results of the chemical analysis, hardness, and tension tests, when specified, and other tests as may be specified in writing by the purchaser.

## 16. Product Marking

16.1 The specification number (the marking need not include the year date of the specification), the name or brand of the manufacturer and the size of tubing or the part number shall be marked on a tag or label securely attached to the bundles or boxes in which the tubes are shipped.

16.2 *Bar Coding*—In addition to the requirements in [16.1](#) bar coding is acceptable as a supplemental identification method. The purchaser may specify in the order a specific bar coding system to be used. In the absence of another bar coding system being specified in the purchase order, bar coding should be consistent with Automotive Industry Action Group<sup>5</sup> [AIAG] standards.

## 17. Keywords

17.1 steel tube

<sup>5</sup> Available from Automotive Industry Action Group AIAG 26200 Lahser Rd, Suite 200, Southfield, MI 48033, www.aiag.org

## SUPPLEMENTARY REQUIREMENTS

One or more of the following supplementary requirements shall apply only when specified by the purchaser in the inquiry, contract, or order. Details of these supplementary requirements shall be agreed upon by the manufacturer and the purchaser.

### S1. Flare Test

S1.1 Braze tubing shall stand being double flared to dimensions shown in SAE Standard J 533, without splitting through the wall at the major diameter of the flare. A separation of the outer lap joint is permissible on the flared end of the tube only in Area A (see Fig. S1.1). This separation shall not exceed 0.12 in. [3.0 mm] in length and shall be confined to the outer thickness only. Seam separation is not permitted in the following areas:

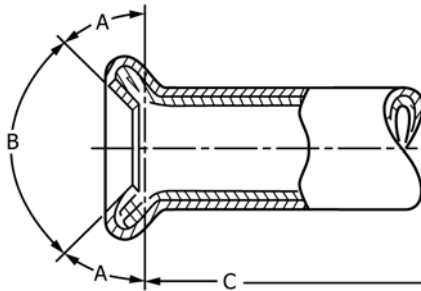

**FIG. S1.1 Double-Flare Test**

S1.1.1 Area B (the flare seat, defined as the surface within the 90° included angle); conical surface shall be smooth and free from cracks or other irregularities that could cause leaks after assembly.

S1.1.2 Area C (the surface beyond the length of the double thickness created by the flare).

S1.2 The flare seat may contain superficial random radial marks or indentations which are not detrimental to the sealability of the flare. No indentations of a repetitive nature resulting from flaring tooling deterioration or adhesion of chips or dirt to the flaring tooling are permissible. In the event that the physical appearance of the flare seat is questioned, the criterion for final judgment is whether or not the flare seat will seal when subjected to a pressure test at the prescribed torque level.

### S2. External Coating

S2.1 The outside surface of the tubing shall be coated with a hot-dipped, lead-tin alloy coating. Weight and composition of coating shall be agreed upon between the manufacturer and purchaser.

### S3. End Finish

S3.1 Finished tubing shall have smooth ends free of burrs.

*ASTM International takes no position respecting the validity of any patent rights asserted in connection with any item mentioned in this standard. Users of this standard are expressly advised that determination of the validity of any such patent rights, and the risk of infringement of such rights, are entirely their own responsibility.*

*This standard is subject to revision at any time by the responsible technical committee and must be reviewed every five years and if not revised, either reapproved or withdrawn. Your comments are invited either for revision of this standard or for additional standards and should be addressed to ASTM International Headquarters. Your comments will receive careful consideration at a meeting of the responsible technical committee, which you may attend. If you feel that your comments have not received a fair hearing you should make your views known to the ASTM Committee on Standards, at the address shown below.*

*This standard is copyrighted by ASTM International, 100 Barr Harbor Drive, PO Box C700, West Conshohocken, PA 19428-2959, United States. Individual reprints (single or multiple copies) of this standard may be obtained by contacting ASTM at the above address or at 610-832-9585 (phone), 610-832-9555 (fax), or service@astm.org (e-mail); or through the ASTM website (www.astm.org). Permission rights to photocopy the standard may also be secured from the Copyright Clearance Center, 222 Rosewood Drive, Danvers, MA 01923, Tel: (978) 646-2600; http://www.copyright.com/*